



For Sale or Lease
1624 Highland Rd.
 Twinsburg, Ohio



Property Description	
Building Size:	33,840 sq. ft. ±
Warehouse:	31,794 sq. ft. ±
Office:	2,046 sq. ft. ±
Year Built:	1982, 2002
Land:	2.43 acres
Zoning:	Industrial
Clear Height:	18' - 20'
Docks:	2 w/levelers & locks
Drive-in Doors:	1-10'; 1-12'
Sprinklered:	Yes-high density, resin & cardboard storage @16.6 GPM over 2,000 sf Group A plastics
Power:	230-480V/2400 amp/3 phase

Plastic injection molding facility with most infrastructure still in place. 80 and 110 ton capacity water cooling towers. Phone and paging system installed with 15 phones.

contact information
 Jeffrey A. Calig, CCIM x 210
 jcalig@naid.us.com
 David R. Hexter, SIOR x140
 dhexter@naid.us.com
 3401 Enterprise Pkw., #105
 Cleveland, OH 44122
 www.naid.us.com
 tel 216 831 3310
 fax 216 831 9869



Commercial Real Estate Services, Worldwide.

Business Property Specialists, Inc. Broker

This information has been secured from sources we believe to be reliable, but we make no representations or warranties, expressed or implied, as to the accuracy of the information. References to condition, square footage or age are approximate. Buyer or Tenant acknowledges that they are relying on their own investigations and are not relying on Broker provided information.

1624 Highland Rd. Site Plan

Twinsburg, Ohio

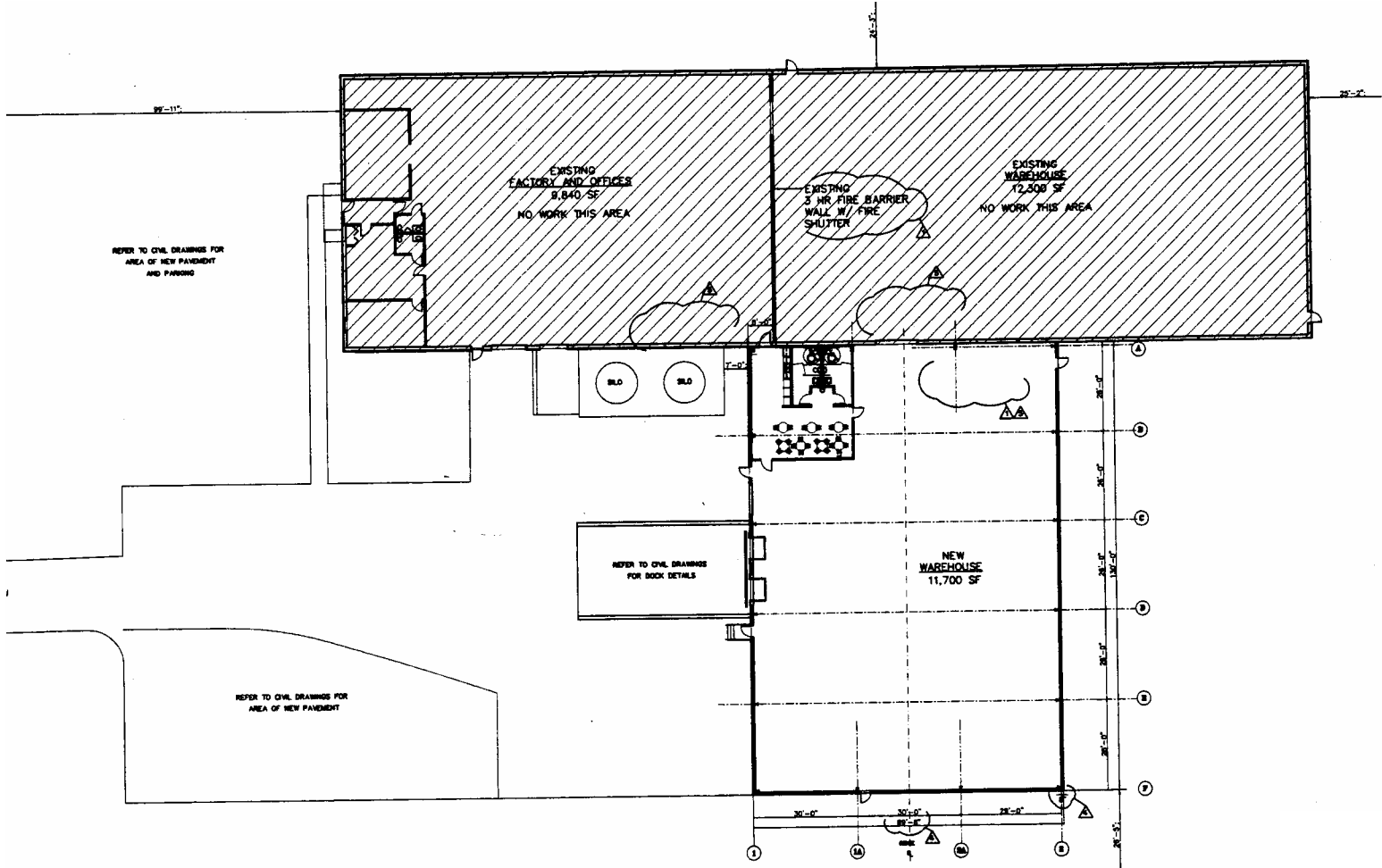

Sale or Lease



Commercial Real Estate Services, Worldwide.

Business Property Specialists, Inc. Broker

contact information
Jeffrey A. Calig, CCIM
David R. Hexter, SIOR
3401 Enterprise Pkw., #105
Cleveland, OH 44122
www.naidaus.com
tel 216 831 3310
fax 216 831 9869

This information has been secured from sources we believe to be reliable, but we make no representations or warranties, expressed or implied, as to the accuracy of the information. References to condition, square footage or age are approximate. Buyer or Tenant acknowledges that they are relying on their own investigations and are not relying on Broker provided information.