



**For Lease**  
**25801 Richmond Rd.**  
 Bedford Heights, Ohio

**Property Description**

**Available :** 15,708 sq. ft.  
**Warehouse:** 13,798 sq. ft.  
**Office:** 1,910 sq. ft.  
**Ceiling Height:** 20' clear  
**Column Spacing:** 40' x 40'  
**Sprinklered:** Yes  
**Docks:** 2  
**Year Built:** 1969

One of the lowest rates in Bedford Heights in the heart of the Builders District. Great access to I-271 & I-480



**FLOOR PLAN ON BACK**

**contact information**

Jeffrey A. Calig, CCIM  
 216 455 0910  
[jcalig@naid.us](mailto:jcalig@naid.us)  
 David R. Hexter, SIOR  
 216 455 0890  
[dhexter@naid.us](mailto:dhexter@naid.us)  
 23240 Chagrin Blvd., Suite 250  
 Cleveland, OH 44122  
[www.naid.us](http://www.naid.us)  
 tel 216 831 3310  
 fax 216 831 9869



Commercial Real Estate Services, Worldwide.  
 Business Property Specialists, Inc. Broker

This information has been secured from sources we believe to be reliable, but we make no representations or warranties, expressed or implied, as to the accuracy of the information. References to condition, square footage or age are approximate. Buyer or Tenant acknowledges that they are relying on their own investigations and are not relying on Broker provided information.

# 25801 Richmond Rd. Floor Plan

Bedford Heights, Ohio

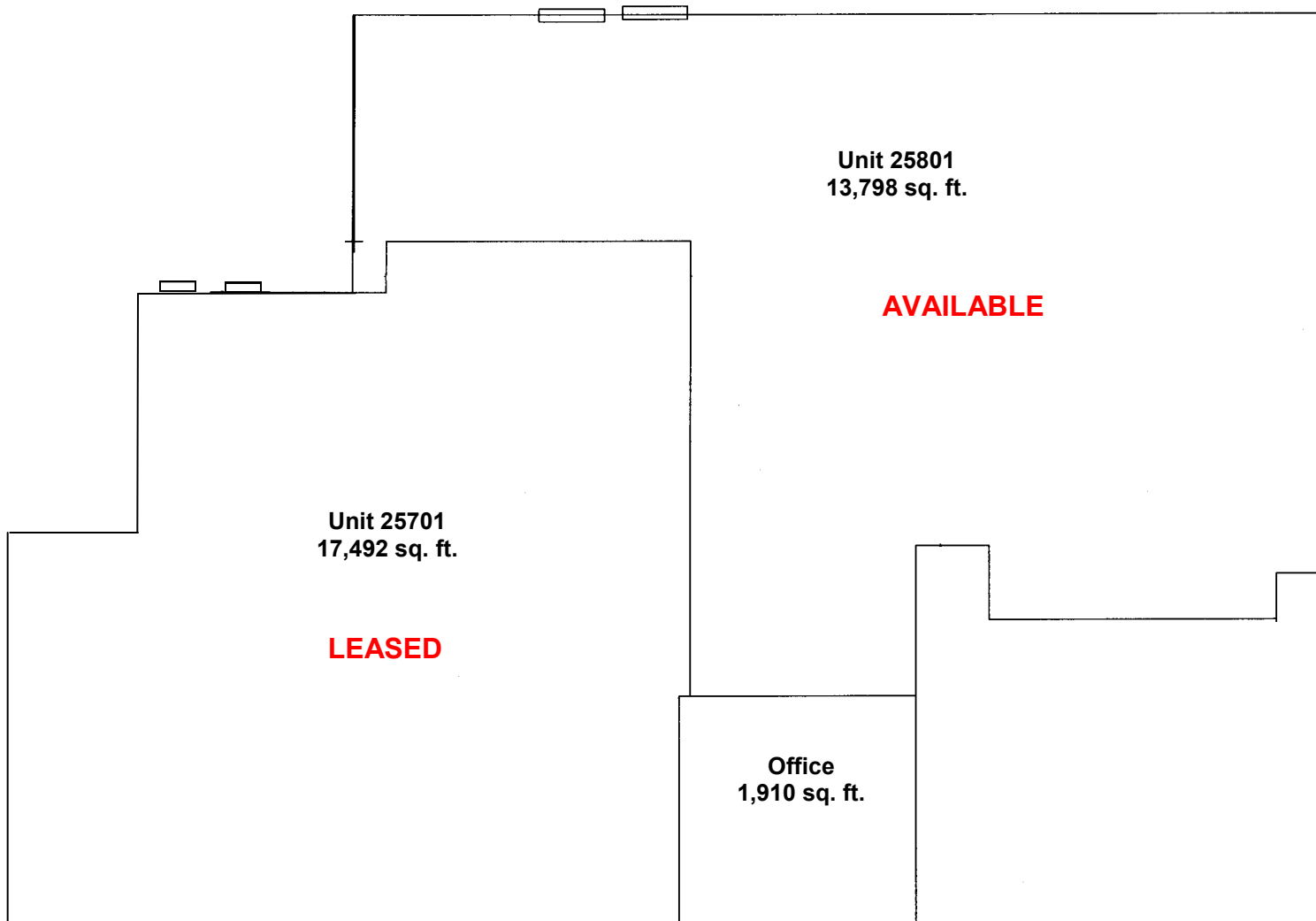

## Industrial For Lease

### contact information

Jeffrey A. Calig, CCIM  
216 455 0910

[jcalig@naidaus.com](mailto:jcalig@naidaus.com)  
David R. Hexter, SIOR  
216 455 0890

[dhexter@naidaus.com](mailto:dhexter@naidaus.com)  
23240 Chagrin Blvd., Suite 250  
Cleveland, OH 44122  
[www.naidaus.com](http://www.naidaus.com)  
tel 216 831 3310  
fax 216 831 9869



Commercial Real Estate Services, Worldwide.  
*Business Property Specialists, Inc. Broker*

This information has been secured from sources we believe to be reliable, but we make no representations or warranties, expressed or implied, as to the accuracy of the information. References to condition, square footage or age are approximate. Buyer or Tenant acknowledges that they are relying on their own investigations and are not relying on Broker provided information.

## BUILDING INFORMATION SHEET

<b>LOCATION:</b>	25801 Richmond Road, Bedford Heights, Ohio
<b>AVAILABLE SQUARE FEET:</b>	15,708 sq. ft.
<b>WAREHOUSE AREA:</b>	13,798 sq. ft.
<b>OFFICE AREA:</b>	1,910 sq. ft.
<b>CONSTRUCTION:</b>	Brick/Block
<b>YEAR BUILT:</b>	1969
<b>LAND AREA:</b>	3.49 acres
<b>ZONING:</b>	Industrial
<b>CEILING HEIGHT:</b>	20' clear
<b>TRUCK DOCKS:</b>	Two
<b>COLUMN SPACING:</b>	40' x 40'
<b>FLOORS:</b>	Concrete
<b>PARKING:</b>	Front parking plus large lot
<b>SPRINKLERED:</b>	Yes
<b>HEAT:</b>	Overhead Gas
<b>LIGHTING:</b>	Fluorescent
<b>ELECTRIC POWER:</b>	240 Volt/200 amp/3 phase
<b>RENTAL RATE:</b>	\$3.25/sq. ft. gross
<b>COMMENTS:</b>	One of the lowest rates in Bedford Heights in the heart of the Builders District. Great access to I-271 and I-480.

**CONTACT:** Jeffrey A. Calig, CCIM 216-831-3310 x210 jcalig@naidaus.com  
David R. Hexter, SIOR 216-831-3310 x140 dhexter@naidaus.com



Commercial Real Estate Services, Worldwide.

Business Property Specialists, Inc., Broker