

22560 Lunn Road  
**Office Building For Sale**  
Strongsville, Ohio

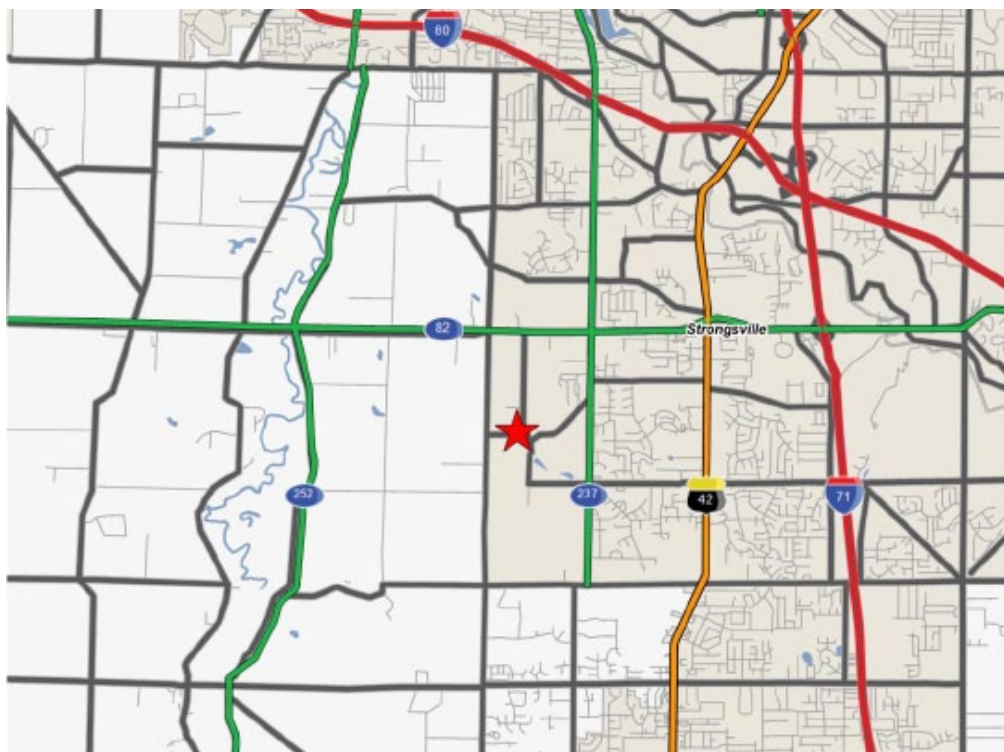

### Property Features

- Sale Price: \$1,400,000
- 2 Story Building Totaling 23,575 ± SF
- 2.849 Acre Site in Foltz Industrial and Business Park
- Built in 2000
- Great Opportunity of an Owner/User
- Open Office Layout with Upgraded Interior Finishes

**NAI Daus**

Commercial Real Estate Services, Worldwide.  
Business Property Specialists, Inc. Broker

[Take A Video Tour](#)

Contact Information

Alec Pacella, CCIM

p 216-455-0925

[apacella@naidaus.com](mailto:apacella@naidaus.com)

[www.naidaus.com](http://www.naidaus.com)

This information has been secured from sources we believe to be reliable, but we make no representations or warranties, expressed or implied, as to the accuracy of the information. References to square footage or age are approximate. Buyer must verify the information and bears all risk for any inaccuracies.

22560 Lunn Road  
**Office Building For Sale**  
Strongsville, Ohio

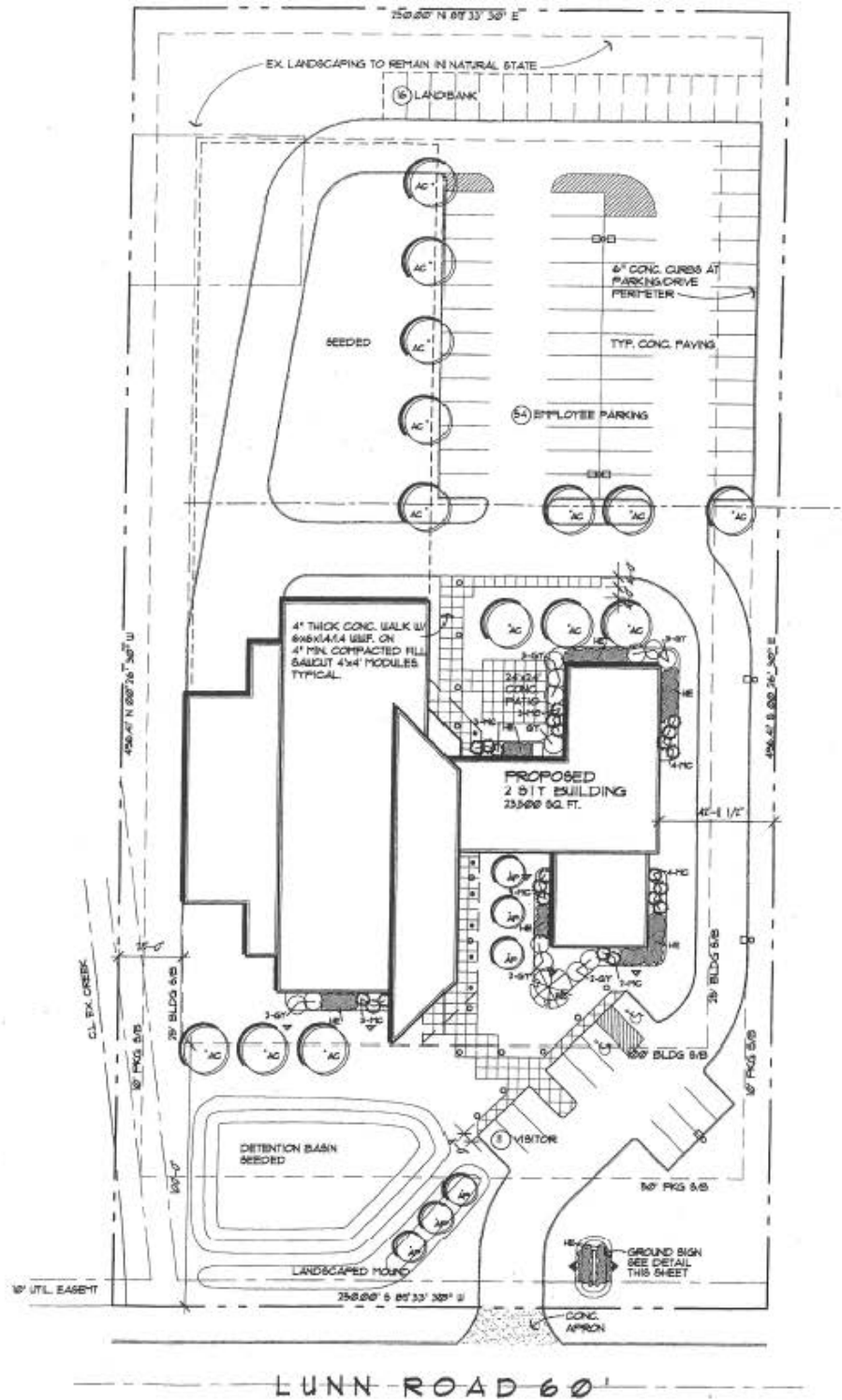

Commercial Real Estate Services, Worldwide.  
Business Property Specialists, Inc. Broker

This information has been secured from sources we believe to be reliable, but we make no representations or warranties, expressed or implied, as to the accuracy of the information. References to square footage or age are approximate. Buyer must verify the information and bears all risk for any inaccuracies.

Contact Information  
**Alec Pacella, CCIM**  
p 216-455-0925  
[apacella@naidaus.com](mailto:apacella@naidaus.com)  
[www.naidaus.com](http://www.naidaus.com)

22560 Lunn Road  
**Office Building For Sale**  
Strongsville, Ohio



Commercial Real Estate Services, Worldwide.  
Business Property Specialists, Inc. Broker

This information has been secured from sources we believe to be reliable, but we make no representations or warranties, expressed or implied, as to the accuracy of the information. References to square footage or age are approximate. Buyer must verify the information and bears all risk for any inaccuracies.

Contact Information  
**Alec Pacella, CCIM**  
p 216-455-0925  
[apacella@naidaus.com](mailto:apacella@naidaus.com)  
[www.naidaus.com](http://www.naidaus.com)