

Retail Site Available

3330 Medina Road

Montville Township, Ohio (Medina)



Property Features

- Site is available for ground lease or build to suit
- Can accommodate up to 4,300 SF building for a single tenant user
- Small space available in a multi-tenant building divisible to 1,240 SF
- End cap with drive thru available
- Adjacent to new Kindercare Daycare
- Traffic Counts of 27,510 ADT
- Located on Medina Road (SR 18) just west of I-71
- High population growth and high income levels



Commercial Real Estate Services, Worldwide.
Business Property Specialists, Inc. Broker

This information has been secured from sources we believe to be reliable, but we make no representations or warranties, expressed or implied, as to the accuracy of the information. References to square footage or age are approximate. Buyer must verify the information and bears all risk for any inaccuracies.

Contact Information

Chris Seelig, Senior Vice President
p 216 455 0926 | cseelig@naidaus.com
www.naidaus.com

Retail Site Available

3330 Medina Road

Montville Township, Ohio (Medina)



Demographics 2009	3 Mile	5 Mile	7 Mile
Population	23,152	47,366	77,545
Average Household Income	\$83,164	\$80,431	\$79,621



Commercial Real Estate Services, Worldwide.
Business Property Specialists, Inc. Broker

This information has been secured from sources we believe to be reliable, but we make no representations or warranties, expressed or implied, as to the accuracy of the information. References to square footage or age are approximate. Buyer must verify the information and bears all risk for any inaccuracies.

Contact Information
Chris Seelig, Senior Vice President
p 216 455 0926 | cseelig@naidaus.com
www.naidaus.com

Retail Site Available

3330 Medina Road

Montville Township, Ohio (Medina)

MEDINA ROAD (STATE ROUTE 18) VARIABLE WIDTH RIGHT OF WAY

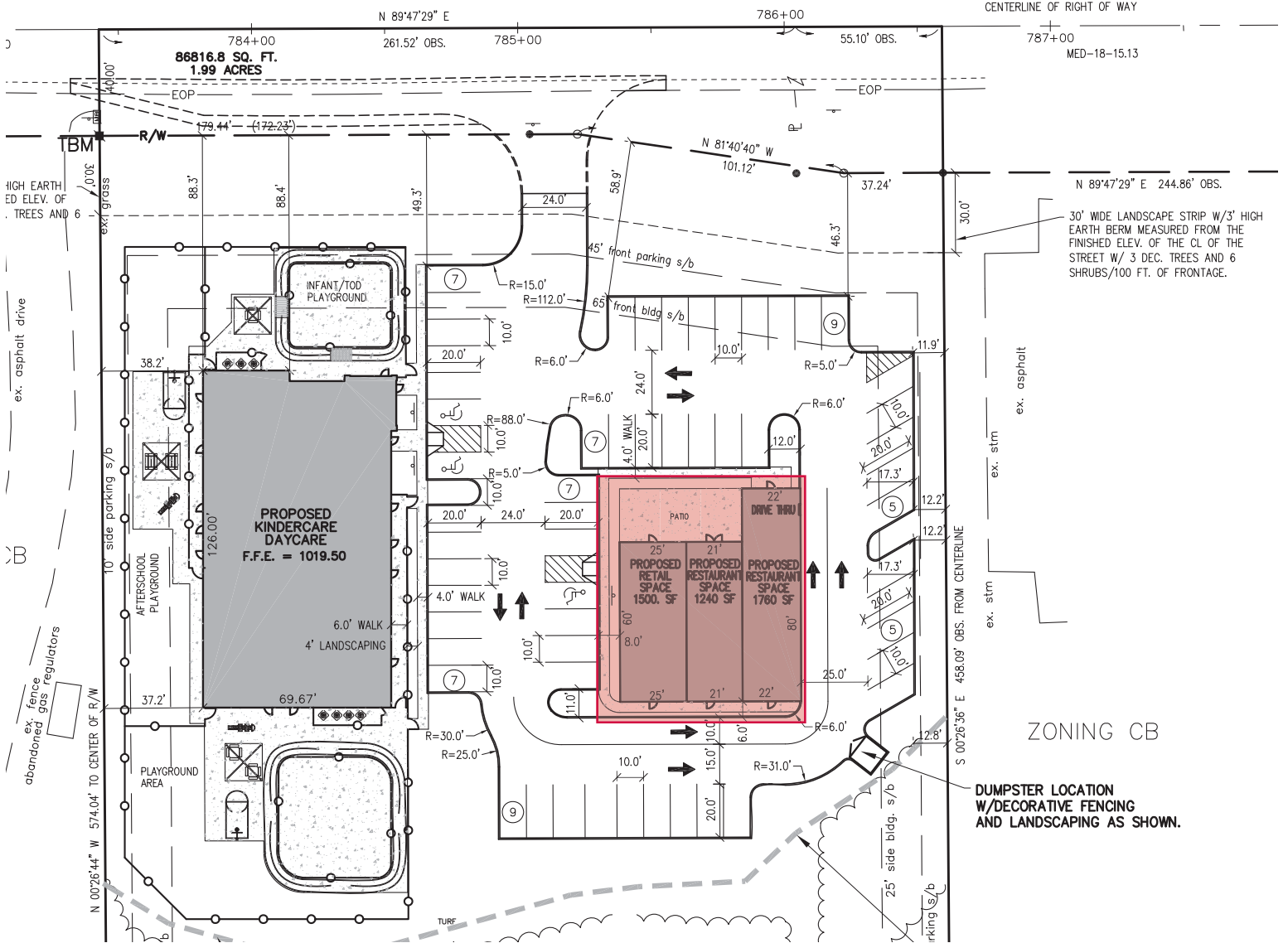

Commercial Real Estate Services, Worldwide.
Business Property Specialists, Inc. Broker

This information has been secured from sources we believe to be reliable, but we make no representations or warranties, expressed or implied, as to the accuracy of the information. References to square footage or age are approximate. Buyer must verify the information and bears all risk for any inaccuracies.

Contact Information
Chris Seelig, Senior Vice President
p 216 455 0926 | cseelig@naidaus.com
www.naidaus.com

Summary Profile

1990 - 2000 Census, 2009 Estimates with 2014 Projections
 Calculated using Proportional Block Groups



Commercial Real Estate Services, Worldwide.
 Business Property Specialists, Inc. Broker

Lat/Lon: 41.13587/-81.80639

3330 Medina Road		3 Miles	5 Miles	7 Miles
Medina, OH				
POPULATION	2009 Estimated Population	23,152	48,635	81,446
	2014 Estimated Population	23,345	49,093	83,000
	2000 Census Population	20,206	41,428	68,450
	1990 Census Population	15,310	30,319	52,108
	Historical Annual Growth 1990 to 2009	2.7%	3.2%	3.0%
	Projected Annual Growth 2009 to 2014	0.2%	0.2%	0.4%
	2009 Median Age	37.2	36.9	37.2
HOUSEHOLDS	2009 Estimated Households	8,428	18,004	30,051
	2014 Projected Households	8,796	18,793	31,690
	2000 Census Households	7,245	15,157	24,917
	1990 Census Households	5,107	10,647	18,079
	Historical Annual Growth 1990 to 2009	3.4%	3.6%	3.5%
	Projected Annual Growth 2009 to 2014	0.9%	0.9%	1.1%
POPULATION BY RACE	2009 Estimated White	95.5%	94.2%	94.4%
	2009 Estimated Black or African American	2.0%	3.3%	2.9%
	2009 Estimated Asian & Pacific Islander	1.5%	1.4%	1.5%
	2009 Estimated American Indian & Native Alaskan	-	-	-
	2009 Estimated Other Races	0.2%	0.2%	0.2%
	2009 Estimated Hispanic	1.4%	1.4%	1.4%
INCOME	2009 Estimated Average Household Income	\$79,392	\$74,540	\$74,627
	2009 Esimated Median Household Income	\$80,779	\$75,474	\$75,301
	2009 Estimated Per Capita Income	\$29,178	\$27,885	\$27,821
EDUCATION (AGE 25+)	2009 Elementary	1.5%	1.7%	2.1%
	2009 Some High School	3.6%	4.7%	5.9%
	2009 High School Graduate	29.1%	35.7%	40.7%
	2009 Some College	26.1%	28.6%	29.7%
	2009 Associates Degree Only	9.9%	9.7%	9.9%
	2009 Bachelors Degree Only	35.3%	32.6%	29.8%
	2009 Graduate Degree	20.0%	18.1%	16.8%
BUSINESS	Number of Businesses	995	2,053	3,036
	Total Number of Employees	11,468	24,379	36,996
	Employee Population per Business	11.5	11.9	12.2
	Residential Population per Business	23.3	23.7	26.8

This report was produced using data from private and government sources deemed to be reliable. The information herein is provided without representation or warranty.

This information has been secured from sources we believe to be reliable, but we make no representations or warranties, expressed or implied, as to the accuracy of the information. References to square footage or age are approximate. Buyer must verify the information and bears all risk for any inaccuracies.