

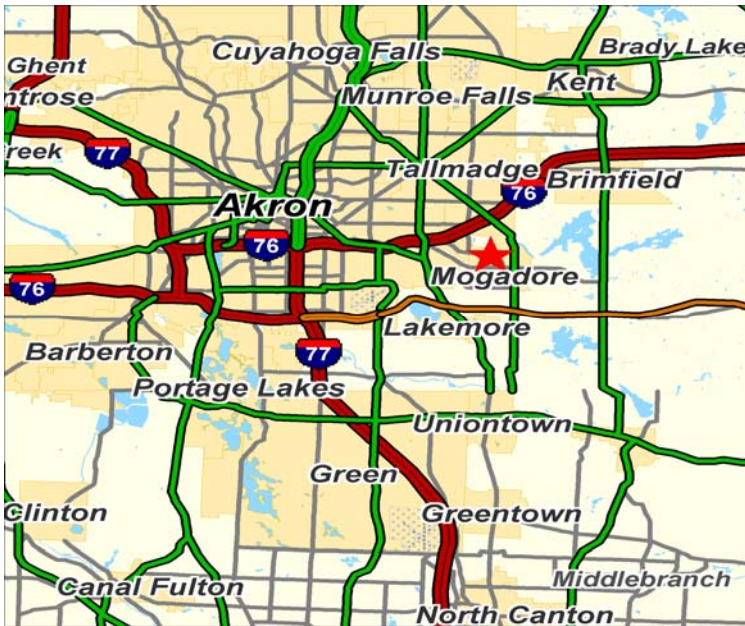

**Available**  
**3111 Gilchrist Rd.**  
 Akron, Ohio



**Property Description**

<b>Building Size:</b>	79,661 sq.ft. ±
<b>Warehouse:</b>	77,963 sq.ft. ±
<b>Office:</b>	1,698 sq.ft. ±
<b>Site</b>	6.47 Acres
<b>Clear Height:</b>	23'
<b>Loading:</b>	8 Docks
<b>Drive Ins:</b>	1
<b>Power:</b>	600 Amps/240V
<b>Sprinkler:</b>	100% wet
<b>Lease Rate:</b>	\$3.25 NNN

**contact information**

**Lisa Trevino**  
 tel. 216-831-3310 Ext. 185  
 ltrevino@naid.us.com  
**William K. Sadatani**  
 Owner Agent  
 tel. 216-831-3310 Ext. 175  
 wsadatani@naid.us.com  
 NAI Daus  
 3401 Enterprise Pkwy.  
 Cleveland, OH 44122  
 tel. 216-831-3310



Commercial Real Estate Services, Worldwide.

Business Property Specialists, Inc. Broker

This information has been secured from sources we believe to be reliable, but we make no representations or warranties, expressed or implied, as to the accuracy of the information. References to condition, square footage or age are approximate. Buyer or Tenant acknowledges that they are relying on their own investigations and are not relying on Broker provided information.

# 3111 Gilchrist Rd. Floor Plan

Akron, Ohio

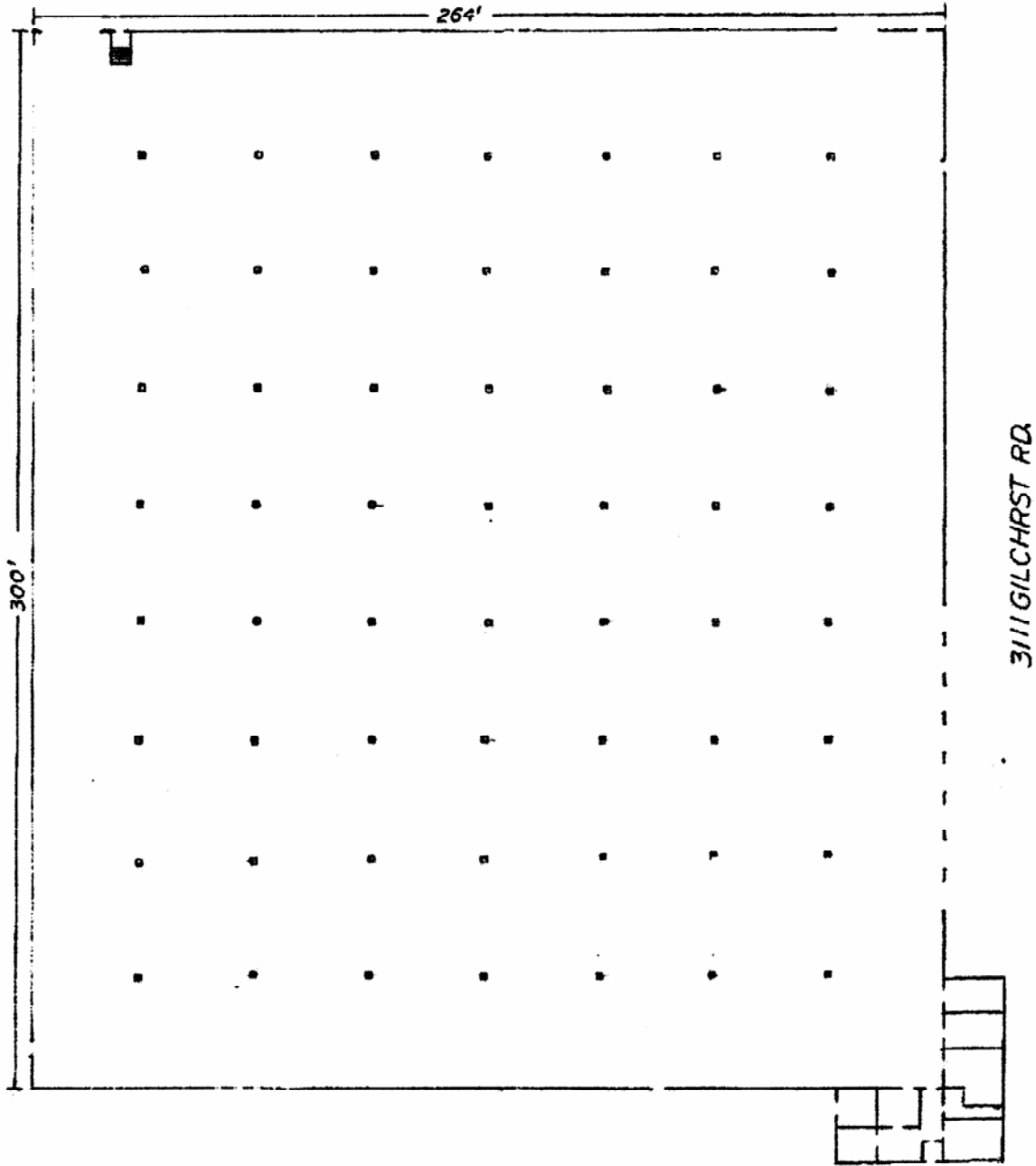

**contact information**

**Lisa Trevino**  
tel. 216-831-3310 Ext. 185  
ltrevino@naidaus.com  
**William K. Sadataki**  
Owner Agent  
tel. 216-831-3310 Ext. 175  
wsadataki@naidaus.com  
NAI Daus  
3401 Enterprise Pkwy.  
Cleveland, OH 44122  
tel. 216-831-3310



Commercial Real Estate Services, Worldwide.

*Business Property Specialists, Inc. Broker*

This information has been secured from sources we believe to be reliable, but we make no representations or warranties, expressed or implied, as to the accuracy of the information. References to condition, square footage or age are approximate. Buyer or Tenant acknowledges that they are relying on their own investigations and are not relying on Broker provided information.