

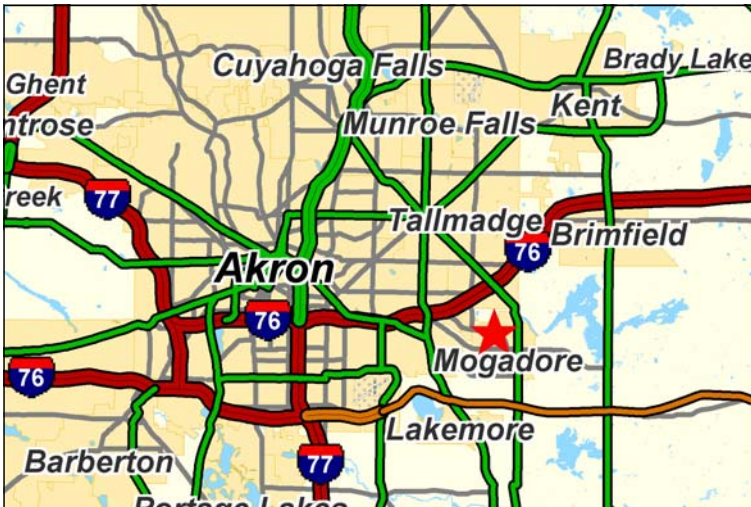

For Lease
3360 & 3400 Gilchrist Rd.
 Mogadore, Ohio



Property Description

Building Size: 334,521 sq.ft. ±
Land: 14.2 Acres ±
Ceiling Height: 24'
Year Built: 1989
Sprinklers: 100% Wet
Access: I-76, I-77, I-80, Rt. 8

Available Space 3360 Gilchrist:

Warehouse: 24,688 sq.ft. ±
Office: 8,996 sq.ft. ±
Docks/Drive-in: 4 / 1

Available Space 3400 A Gilchrist:

Warehouse: 20,500 sq.ft. ±
Office: 9,500 sq.ft. ±

Docks/Drive-in: TBD

Located In a premier distribution submarket in northern Ohio.



Commercial Real Estate Services, Worldwide.

Business Property Specialists, Inc. Broker

contact information

Lisa Trevino
 tel. 216-831-3310 Ext. 185
 ltrevino@naidaus.com
William K. Sadataki
 Owner Agent
 tel. 216-831-3310 Ext. 175
 wsadataki@naidaus.com

23240 Chagrin Blvd.
 Cleveland, OH 44122

This information has been secured from sources we believe to be reliable, but we make no representations or warranties, expressed or implied, as to the accuracy of the information. References to condition, square footage or age are approximate. Buyer or Tenant acknowledges that they are relying on their own investigations and are not relying on Broker provided information.

3360 Gilchrist Road Floor Plan

Mogadore, Ohio

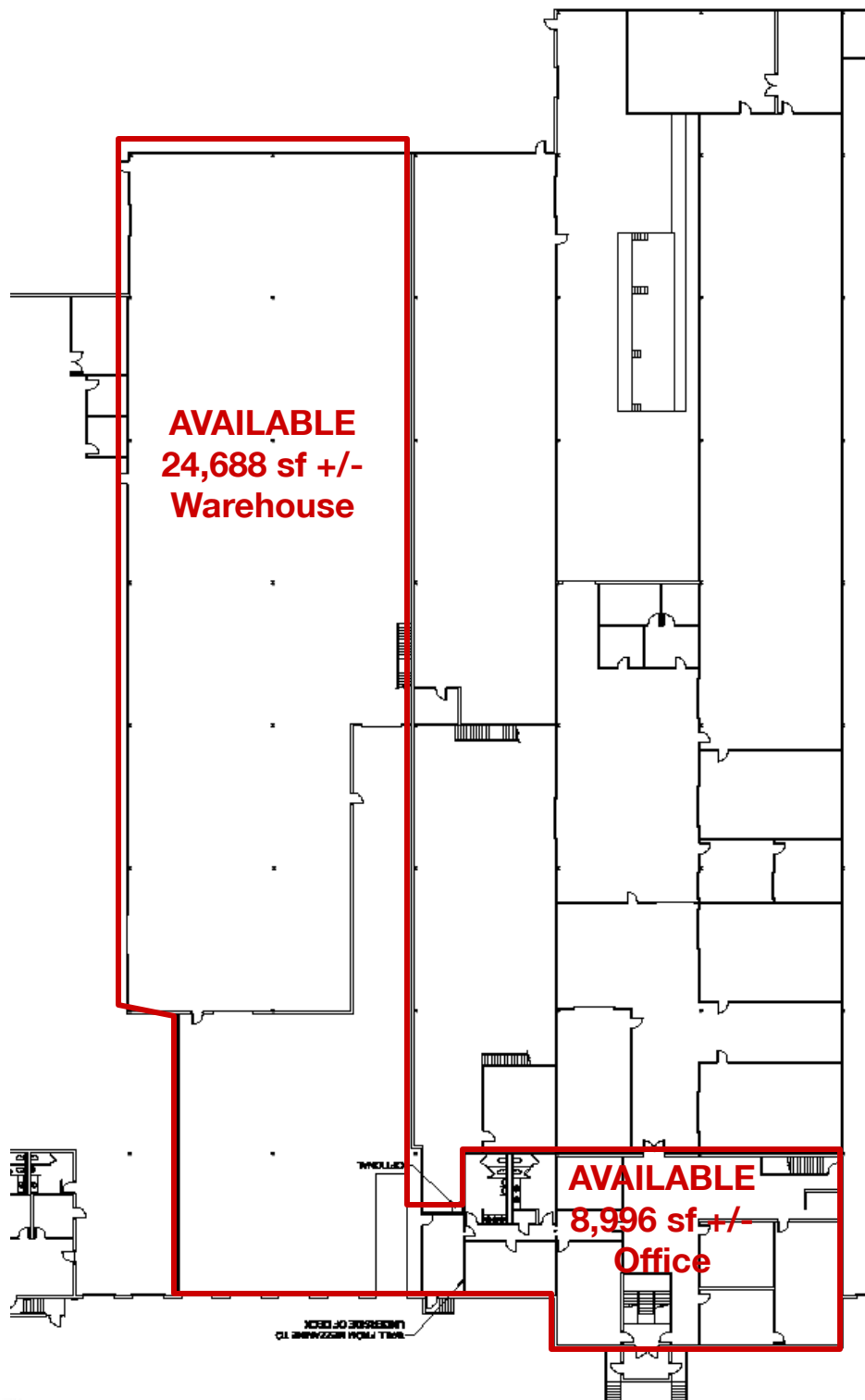

contact information

Lisa Trevino
tel. 216-831-3310 Ext. 185
ltrevino@naid.us.com
William K. Sadataki
Owner Agent
tel. 216-831-3310 Ext. 175
wsadataki@naid.us.com
NAI Daus
3401 Enterprise Pkwy.
Cleveland, OH 44122
tel. 216-831-3310
Fax. 216-831-9869



Commercial Real Estate Services, Worldwide.

Business Property Operations, Inc. Broker
This information has been secured from sources we believe to be reliable, but we make no representations or warranties, expressed or implied, as to the accuracy of the information. References to condition, square footage or age are approximate. Buyer or Tenant acknowledges that they are relying on their own investigations and are not relying on Broker provided information.

3400 Gilchrist Road Site Plan

Mogadore, Ohio

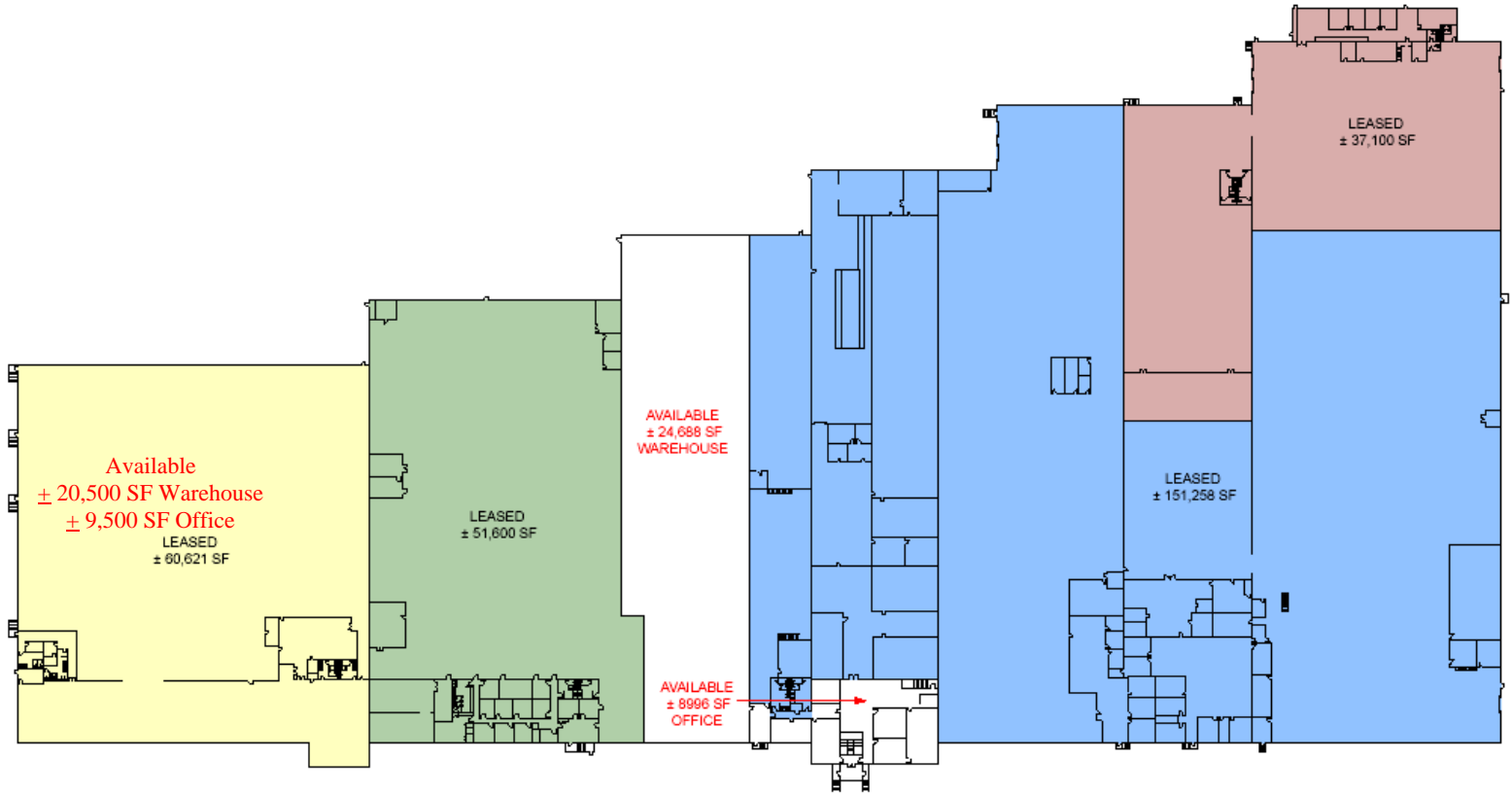

contact information

Lisa Trevino
tel. 216-831-3310 Ext. 185
ltrevino@naid.us.com

William K. Sadataki
Owner Agent
tel. 216-831-3310 Ext. 175
wsadataki@naid.us.com
NAI Daus
3401 Enterprise Pkwy.
Cleveland, OH 44122
tel. 216-831-3310
Fax. 216-831-9869



Commercial Real Estate Services, Worldwide.

Business Property Operations, Inc. Broker

This information has been secured from sources we believe to be reliable, but we make no representations or warranties, expressed or implied, as to the accuracy of the information. References to condition, square footage or age are approximate. Buyer or Tenant acknowledges that they are relying on their own investigations and are not relying on Broker provided information.